

# LAKEMBA LINK

## Term 4 – Week 2



Alice Street South, Wiley Park 2195

P: 02 9759 2915 E: lakemba-p.school@det.nsw.edu.au

### Important Dates

Tuesday 5 <sup>th</sup> October	First day of Term 4 for everyone Learning from Home
Thursday 16 <sup>th</sup> December	Last day of school for 2021
Friday 28 <sup>th</sup> January	Staff Development Day
Monday 31 <sup>st</sup> January	Staff Development Day
Tuesday 1 <sup>st</sup> February, 2022	First day of school for students in Stage 1, Stage 2 and Stage 3
Thursday 3 <sup>rd</sup> February	First day for Kindergarten 2022 students

- keep moving and not stop to talk to teachers or other parents.
- leave the school as soon as they have picked up their children.

All parents must walk up the school driveway and continue past the Kindergarten rooms. They will proceed by the back of the demountable classrooms to Area A where they will pick up their Stage 1 and Stage 2 students. They will continue through the Square and down the path out of the school. Stage 3 students will be waiting on the grass. Please see the map below.

Dear Parents and Carers,

Welcome to Term 4 and the imminent return of students returning to school. We are really looking forward to welcoming Kindergarten and Year 1 back on Monday 18<sup>th</sup> October and everyone else on Monday 25<sup>th</sup> October.

Thank you for being so supportive during the time we have been Learning from Home. Together we are a great team!!!

Take care and stay safe.

Kind regards,  
Jann Price

### Return to School Guidelines

Monday 18<sup>th</sup> October – Kindergarten and Year 1

Monday 25<sup>th</sup> October – All students

When students return to school all learning will be face to face. The school will no longer provide Learning from Home packs.

#### Morning

- Students will be met at the gate by teachers. Parents will not be able to enter the school grounds.
- Two playgrounds will be in use – one for K – 2 and one for 3 – 6 students.

#### Afternoon

Students who are picked up by their parents or carers will be released in their Sport House group at different times.

Students who walk home on their own will be released at 3pm.

2.25pm – Barrington (Blue House) –

2.35pm – Grafton (Green House)

2.45pm – Richmond (red House)

2.55pm – Yalumba (Yellow House)

3pm – Students who walk home on their own.

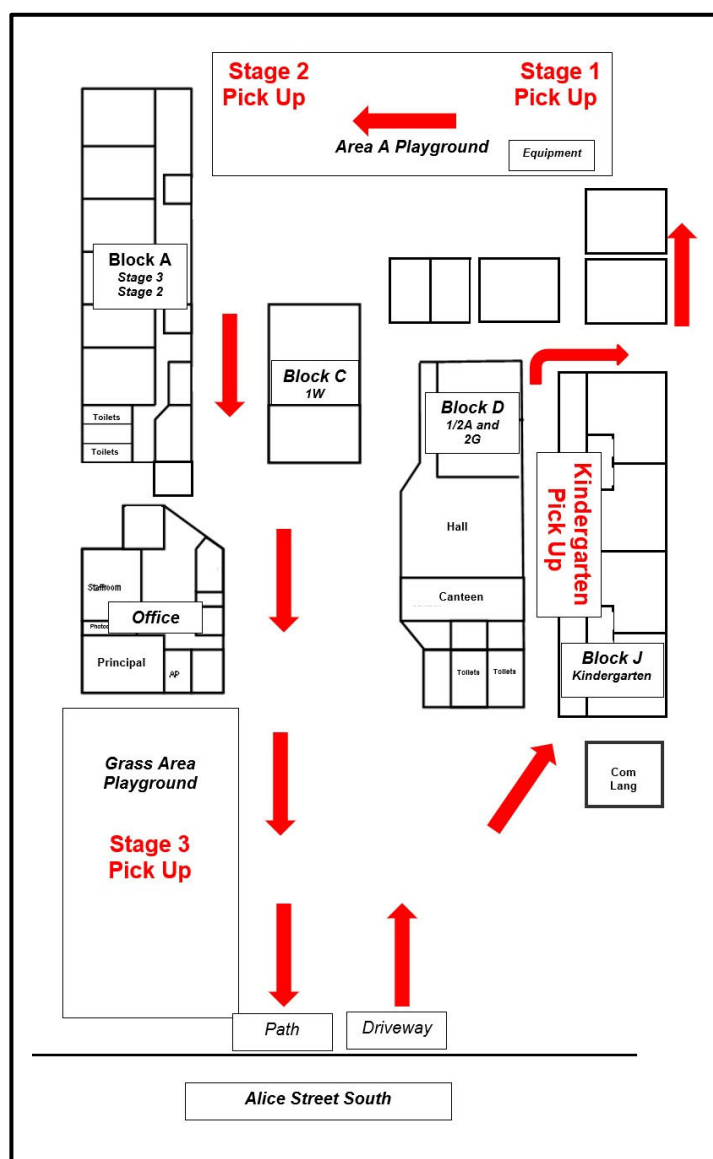

When picking up their children all parents and carers must:

- wear a mask.
- socially distance.

### Staff News

Congratulations to Ms Adhami and her husband who welcomed their daughter early in September.

Congratulations to Mrs Ghantous and her family who welcomed their new little girl in to their family at the end of September.

On Friday we farewelled Mrs Furda who is beginning maternity leave to prepare for the birth of her first child. We wish Mrs Furda, her husband and their extended family well and look forward to hearing all about their beautiful baby later in the year.

Mrs Shammi will be teaching 2F for the rest of the year. Mrs Furda and Mrs Shammi have been working together to ensure that the student learning continues as planned. Mrs Shammi is working closely with the Stage 1 team.

### School Visitor Check-in

A single School Visitor Check-in system for every school in NSW is coming from 18 October!

The Department of Education has partnered with Service NSW to provide a streamlined, digital school sign-in system for visitors and contractors at every NSW government school.

Benefits of the new system include:

- accelerating your check-ins to as fast as 20 seconds!
- linked to NSW Health's COVID-19 contact tracing ensuring every school is compliant with the [NSW COVID-19 mandate](#).
- giving every school greater access to streamlined NSW Government services.

You can watch a short [parent video](#) External link to see how it works for parents or our [contractor video](#) External link.

## Canteen Open November 1



### School Planning 2022

To assist us in planning for 2022, could you please notify the front office on 9759 2915 if your child will not be returning to Lakemba Public School next year. This does not include Year 6 students going to high school.

### Opportunity Class 2022

Due to the ongoing COVID restrictions this year's Opportunity Class Placement Test has been rescheduled to **Wednesday, 17 November 2021**. It has been agreed by the Minister that the test will be administered as a computer-based test in a process similar to the Check In assessments.

To ensure that students can be placed at the beginning of the 2022 school year students who applied for OC placement will be tested at their own school.

### Selective High School 2023

Current Year 5 students who wish to apply for selective High Schools in 2023 can apply online from 19 October 2021 to 17 November 2021.

Information is available at

<https://education.nsw.gov.au/public-schools/selective-high-schools-and-opportunity-classes/year-7>

All candidates are required to sit the Selective High School Placement Test to be held on Thursday 10 March 2022.

## Building Works

While you have been Learning from Home there has been lots of work going on at the school.



### Kindergarten Enrolments

We are currently planning for our 2022 Kindergarten enrolments. Children who turn 5 before 1<sup>st</sup> August 2022 are eligible to begin school next year. Parents and carers should complete the application online through the link on the school website.

<https://lakemba-p.schools.nsw.gov.au/>

Our administrative staff are able to process these enrolments and contact families to obtain further information. Please pass on this message to any family, friends, or neighbours.

Families who have enrolled online will be contacted about Kindergarten Orientation early in Term 4. At this stage orientation will probably be online rather than onsite. If you have any questions please contact the school.

Due to current restrictions, we are unable to run our usual Leapfrogs program for students beginning school in 2022.

### School Planning 2022

To assist us in planning for 2022, could you please notify the front office on 9759 2915 if your child will not be returning to Lakemba Public School next year. This does not include Year 6 students going to high school.

### School Security

Please help keep our school safe. If you see anything unusual happening in the school grounds at any time, please call School Security on 1300 880 021

## School as Community Centre News

Welcome back everyone – hope you enjoyed some screen free time during the holidays and some of the lovely weather as well. It is exciting to be emerging from this long lockdown and I'm sure the children are looking forward to returning to school and seeing their teachers and friends. Perhaps, like me, you also feel a little nervous about this which is very understandable.

Unfortunately, due to Department of Education Covid Safe plans for schools, we will not be starting any face to face groups in the Centre probably until next year. I will miss catching up with your little ones in person but really enjoy your posts and photos on the WhatAapp groups.

I will continue to post a story every Wednesday and join Rojalin and Satarala from Save the Children for Chai and Chat (online) at 11.30 Wednesdays. Let me know if you'd like to join as well. We are also planning an online program of Transition to School for those who are interested and will aim to support you and your children to be ready for the start of school in 2022.

Speech therapy: If you have a young child who is on a waiting list for speech therapy or an assessment please contact Wendi at lakembasacc@gmail.com as there are some online sessions this term in partnership with Sydney University. There are three FREE online webinars called "Dealing with Child and Parent Anxiety after Covid" which are on 15th, 22nd and 29th October from 10.30-12.00 run by a psychologist which might be helpful. The sessions provide an opportunity for personal discussion as well. To register go to <https://www.eventbrite.com.au/e/dealing-with-child-and-parent-anxiety-after-covid-tickets-188017414147>.

Mental Health Support: A clinic for those experiencing mental health concerns as a result of the Covid 19 pandemic is located at the ISRA Medical Centre 102A Haldon St Lakemba. The federally funded clinic is open Monday to Friday from 8:30-5:30. They have two female staff; a qualified counsellor and a mental health nurse. You can walk in to book or call 1800 595212.

Back on Track with 123 Magic. Is a 3 week parent program which will be delivered online to help families with strategies to improve family relationships post the lockdown. Wednesdays 10th, 17th and 24th November from 1.00-3.00 each week. To register call Kay Oo on 9789 3744 or email [kay.oo@metroassist.org.au](mailto:kay.oo@metroassist.org.au)

For Pre-schoolers: There are some fabulous early childhood lessons and resources written by the Department of Education Early Childhood staff for parents to do at home if their children are not going to childcare at the moment. Some great ideas for home learning for the under 5's. Go to <https://sites.google.com/education.nsw.gov.au/ec-guided-learning/home>

All the information about community programs are posted on our Facebook page.

Go to <https://www.facebook.com/LakembaSaCC/>



Ring Wendi on 0404 015 001 for more information or just for a chat.

### 2022 School Terms

These dates are the dates that students must attend school.

<b>Term 1</b>	Tuesday 1 <sup>st</sup> February	Friday 8 <sup>th</sup> April
<b>Term 2</b>	Wednesday 27 <sup>th</sup> April	Friday 1 <sup>st</sup> July
<b>Term 3</b>	Tuesday 19 <sup>th</sup> July	Friday 23 <sup>rd</sup> September
<b>Term 4</b>	Monday 10 <sup>th</sup> October	Monday 19 <sup>th</sup> December

# Wellbeing Wednesday

## STEM Scavenger Hunt

STEM stands for Science, Technology, Engineering and Mathematics.

For the Week 1 Wellbeing Wednesday activity, students were involved in a STEM Scavenger Hunt and thought about the different STEM words. Have a look at their creativity!

Find as many items that relate to STEM and record what you find.	
Find something that is sloping down or up.	Find something that can be recycled.
Find something that beeps.	Find something that follows a pattern.
Find something that will float.	Find something that is taller than you.
Find something that has four sides.	Find something that makes noise.



Anas KB

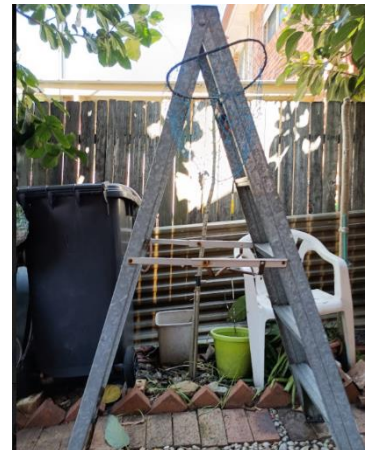

Zayn KB

Find something that is sloping down or up.	wheel
Find something that beeps.	phone car horn
Find something that will float.	Ball Boat
Find something that has four sides.	TISSUE box
Find something that can be recycled.	Pizza box Bottle
Find something that follows a pattern.	Ludo
Find something that is taller than you.	Door
Find something that makes noise.	Vacuum

Ahnaf KA

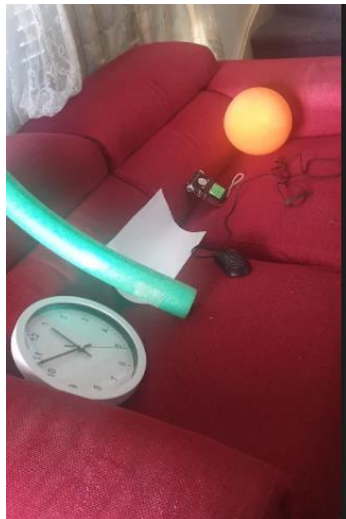

Joseph 2F



Ayaan.M 2F

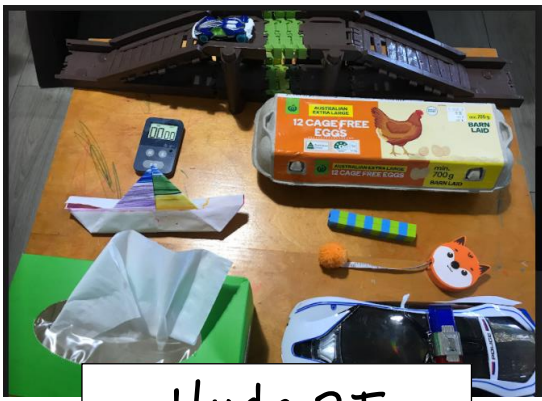

Huda 2F



Fares 2F

Sloping down/up MP	recycled Plastic cup ☐
beeps clock bees	follows a Pattern Mat
float Boat	taller than me door, roof
four Box ☐	makes noise vacuum cleaner

Marsad 2G

1. Find something that is sloping down or up.  
Ans: - Slime

2. Find something that can be recycled.  
Ans: - Plastic drink bottle.

3. Find something that beeps.  
Ans: - Car

4. Find something that is taller than you.  
Ans: - Ladder.

5. Find something that will float.  
Ans: - Boat.

6. Find something that follows a pattern.  
Ans: - □□□□□□□□

7. Find something that has four sides.  
Ans: - □ or table.

8. Find something that makes noise.  
Ans: - TV.

Sarahnur 2G

Something sloping down or up - Slide  
 Something recycled - Plastic Jar  
 Something beeps - car horn  
 Something that follows a pattern - red and green patterns in my block  
 Something that floats - plastic ball  
 Something taller than me - stand fan  
 Something has 4 sides - TV  
 Something makes noise - Doll

Alveena 2F



Ayesha 1N



Lilliana 2G



Hamdan 2G

Find something that is sloping down or up. Stairs	Find something that can be recycled. Bottle
Find something that beeps. clock	Find something that follows a pattern. Kitchen tiles
Find something that will float. lego	Find something that is taller than you. Fridge
Find something that has four sides. TV	Find something that makes noise. Tablet

Aisha 2G



Jana 2G

1: something that beeps: a fire alarm 🔔

2: something that follows a pattern: a rubiks pattern

3: something slope: a toy rode



4: something that has 4 sides: a box 📦

5: something that makes noise: music box 🎵

6: something that floats: a plastic fork 🍴

7: something that can be recycled: a box 📦

**SCAVENGER HUNT! CCT**

	image.jpg Image		image.jpg Image
	image.jpg Image		image.jpg Image
	image.jpg Image		image.jpg Image
	image.jpg Image		

Aisha.S 3E